

Energy efficient hot air recycling
with LE 5000 DF air heater
on a shrinking tunnel.



Air heater

LE 10000 DF



Installation dimensions in mm

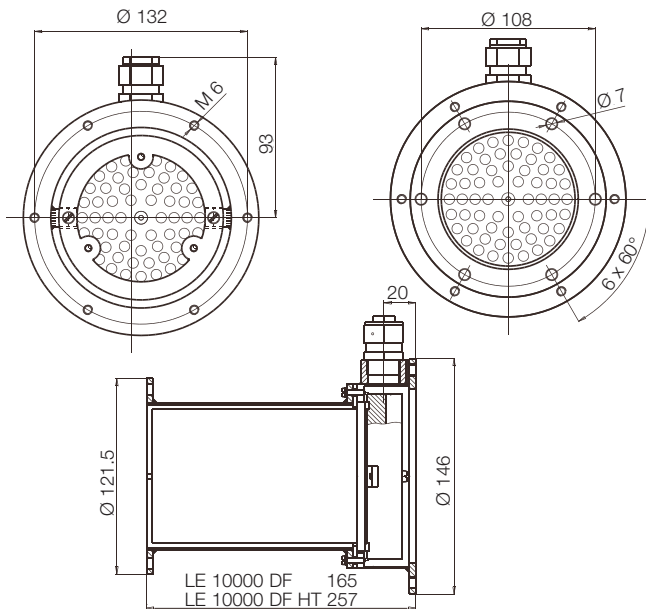

Technical data LE 10000 double flange

		LE 10000 DF	LE 10000 DF HT
Easy to integrate in existing air systems		•	•
Suitable for recycling air		•	•
Simple and safe fixture options		•	•
No integrated power electronics		•	•
Max. air outlet temperature °C		650	900
Min. air flow	l/min 5.5 kW	600	
	11 kW	1200	
	17 kW	2200	
	15 kW HT		1200
Max. air inlet temperature °C		160	160
Max. ambient temperature °C		100	100
Weight including 5 m silicon cable kg		3.4	4.0
Mark of conformity		CE	CE
Protection classe I		⊕	⊕

Optional power controller

DSE three-phase controller (page 51)

Optional temperature regulation

DSE three-phase controller (page 51) and KSR DIGITAL temperature regulator (page 50)

Voltage V ~	3 × 400	3 × 400	3 × 400	3 × 400
Power consumption kW	5.5	11	17	15
LE 10000 DF Order no.	115.571	114.555	116.135	
LE 10000 DF HT Order no.				116.056
LE 10000 DF sealed Order no.			130.865	

Additional versions available on request