

Double-flange air heaters: The recycling specialists.

Reduced to the max! These double-flange air heaters are suitable for integration into air duct systems. The inlet air temperature can be as high as 160 °C (in special versions up to 300 °C) so preheated air can be reused and recycled.

Air heater

LE 5000 DF



Technical data LE 5000 double flange

Easy to integrate in existing air systems		•
Suitable for recycling air		•
Simple and safe fixture options		•
No integrated power electronics		•
Max. air outlet temperature	°C	700
Min. air flow	l/min 4.5 kW / 6.5 kW 7.5 kW	800 1000
Max. air inlet temperature	°C	160
Max. ambient temperature	°C	100
Weight including 5 m silicon cable	kg	1.9
Mark of conformity		CE
Protection classe I		⊕

Installation dimensions in mm

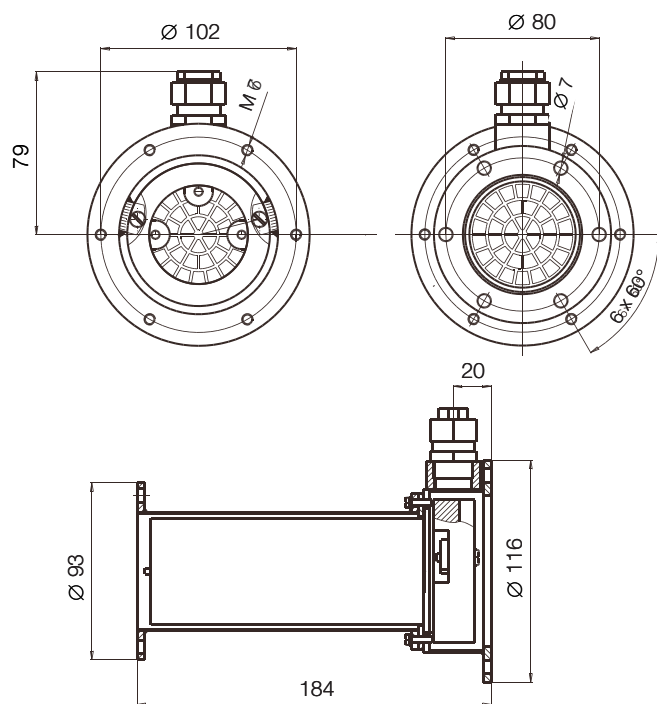

Optional power controller

DSE three-phase controller (page 51)

Optional temperature regulation

DSE three-phase controller (page 51) and KSR DIGITAL temperature regulator (page 50)

Voltage V ~		3 × 400	3 × 400	3 × 400
Power consumption kW		4.5	6.5	7.5
LE 5000 DF	Order no.	117.551		114.240
LE 5000 DF sealed	Order no.		127.872	

Additional versions available on request